



Aurora Point, London, SE8 3FQ

A stylish one bedroom, one bathroom apartment located in Rotherhithe. A short walk away from Greenland Surrey Quays Pier with ferry access to Canary Wharf and great bus links. Featuring a sleek open plan kitchen and living space with modern appliances and access to spacious private balcony. Boasting a bright, generous bedroom with floor to ceiling windows and a well-kept family bathroom. Within walking distance to many local amenities such as a gym, supermarkets, local deli, restaurants and cafes as well as a concierge by the main entrance to the building.

- Ferry Access to Canary Wharf
- One Bedroom Apartment
- Fully Furnished
- Modern Kitchen
- Open-Plan Living
- Good Transport

Alex & Matteo
ESTATE AGENTS

£2,000 Per month

Winchester Square, London, SE8

Approximate Area = 610 sq ft / 56.6 sq m

For identification only - Not to scale

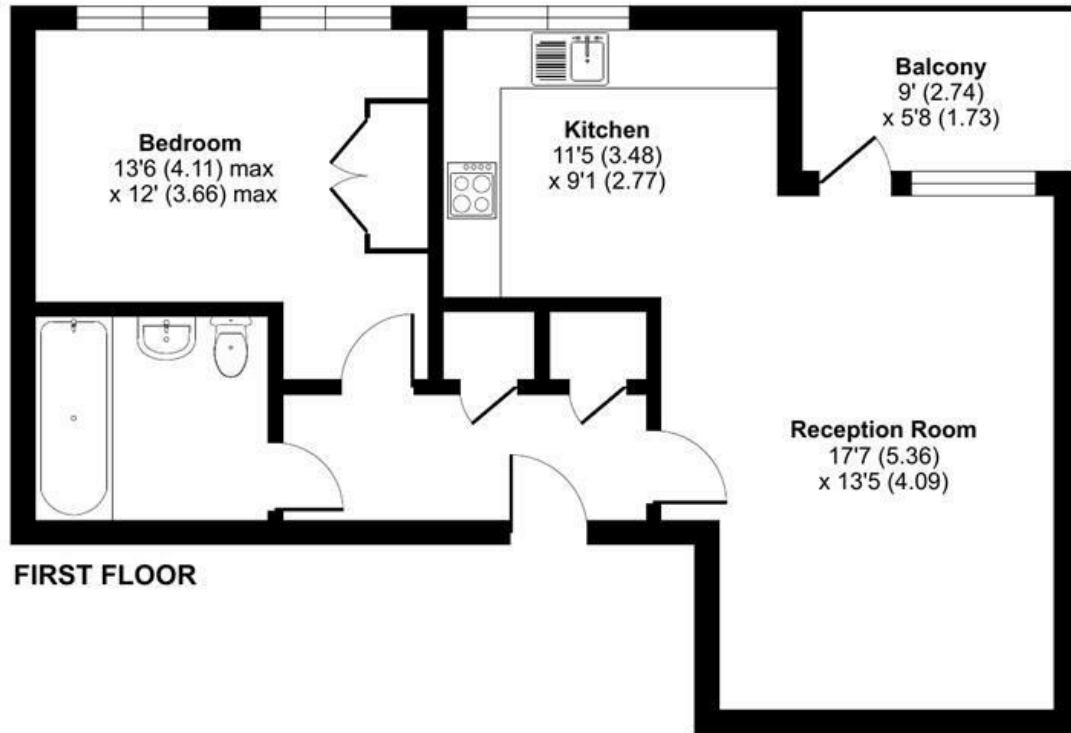

FIRST FLOOR

Alex & Matteo
ESTATE AGENTS



**Certified
Property
Measurer**

Floor plan produced in accordance with RICS Property Measurement Standards incorporating International Property Measurement Standards (IPMS2 Residential). © nitchcom 2024. Produced for Alex & Matteo Estate Agents. REF: 1131401

Energy Efficiency Rating		
	Current	Potential
Very energy efficient - lower running costs		
(92 plus) A		
(81-91) B	83	83
(69-80) C		
(55-68) D		
(39-54) E		
(21-38) F		
(1-20) G		
Not energy efficient - higher running costs		
England & Wales		
EU Directive 2002/91/EC		